

- Throttle valve size 1 ... size 4
- Line mounting valve
- Brass body
- up to 210 bar, 60 l/min

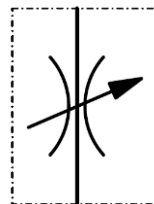

Description

Series EVN units are pipe-mounting throttle valves with threads from G 1/8" to G 1/2".

The throttling is made by an annular gap or an eroded slot (micro fine adjustment).

Technical Data

General Specifications	EVN
Design:	annular gap throttling or eroded slot
Mounting method:	pipe-mounting valves
Size:	G1/8" ... G1/2" (see table dimensions)
Mounting position:	any

Hydraulic Specifications	
Max. operating pressure:	210 bar
Max. volume flow:	60 l/min
Fluid:	hydraulic oils, water and compressed air
Temperature range:	-20°C ... +90°C (NBR) -60°C ... +200°C (FKM)

Characteristics (annular gap throttling)

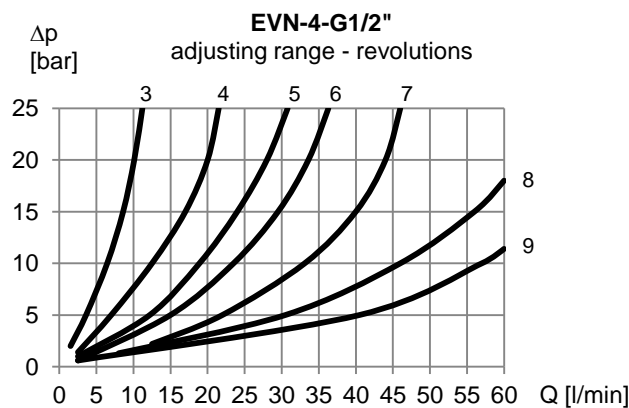
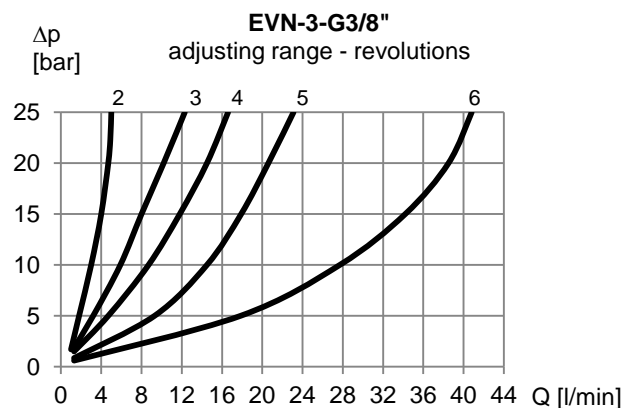
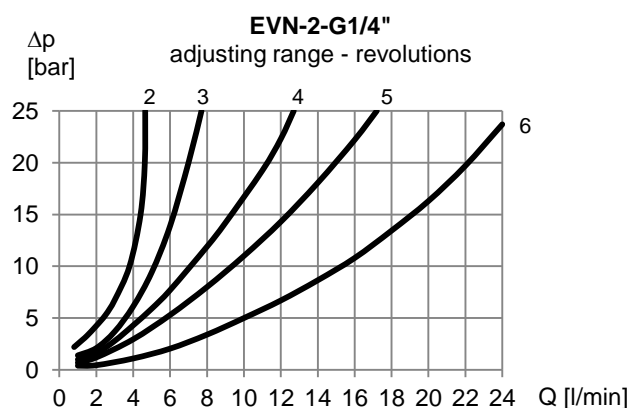
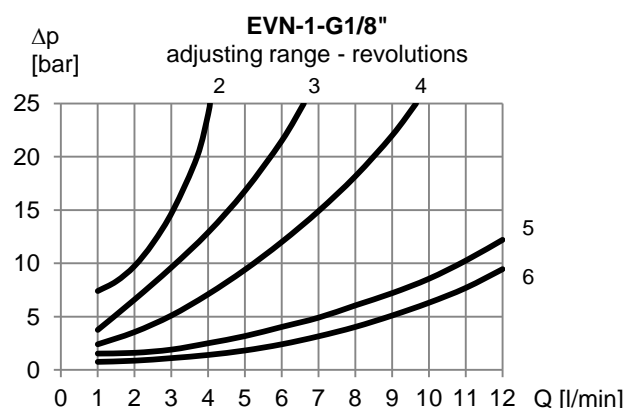

Pressure difference Δp at constant throttle position in relation to the volume flow Q

Oil temperature $t_{oil} = 50^\circ C$
 Viscosity $\nu = 35 \text{ mm}^2/s$

Special execution with micro fine adjustment:

Eroded slot, available with different slot width:

- EVN-1-G1/8" slot width 0,16mm and 0,20mm
- EVN-2-G1/4" slot width 0,16mm, 0,20mm and 0,30mm
- EVN-3-G3/8" slot width 0,20mm, 0,30mm and 0,40mm
- EVN-4-G1/2" slot width 0,30mm, 0,40mm and 0,50mm

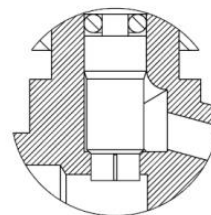

Characteristics (throttling by eroded slot)

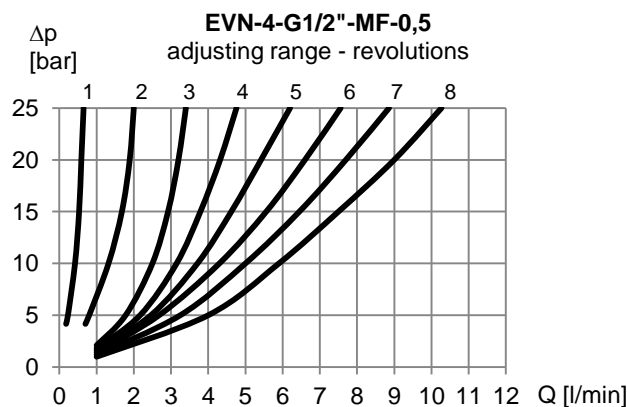
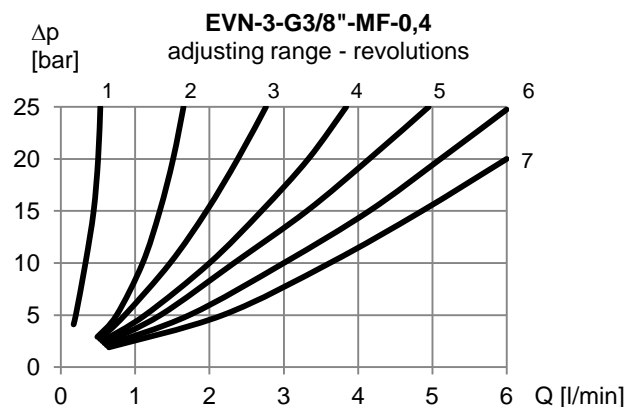
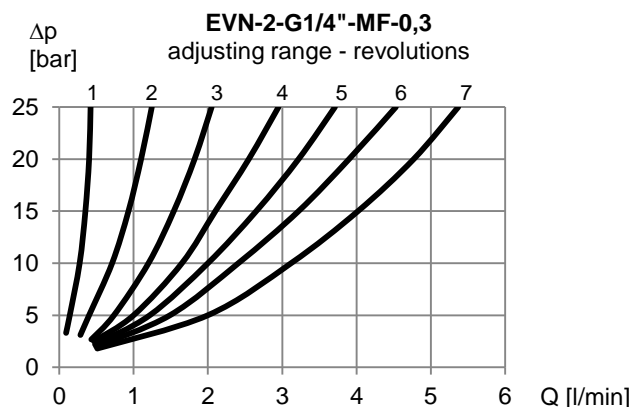
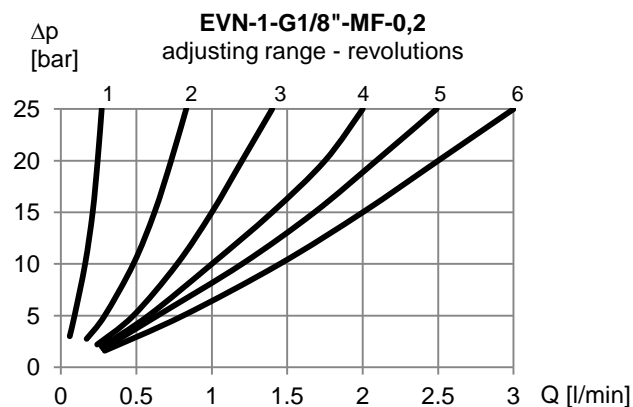

Pressure difference Δp at constant throttle position in relation to the volume flow Q

- Oil temperature $t_{oil} = 50^{\circ}C$
- Viscosity $\nu = 35 \text{ mm}^2/s$

Dimensions

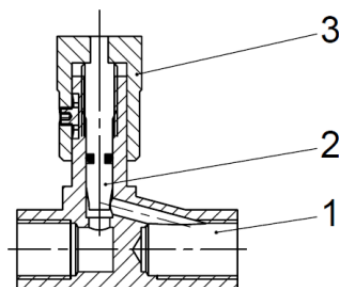
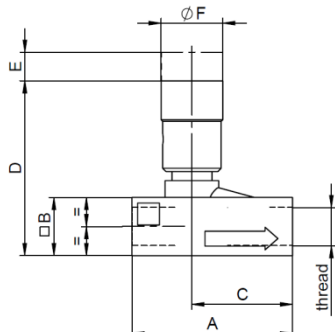

Item	Qty.	Description	Material
1	1	valve body	brass
2	1	spindle	stainless steel
3	1	adjusting knob	aluminium

	Size	Thread	A	B	C	D	E	øF	Weight kg
EVN-1	NW 6	G1/8"	38,5	14,0	23,0	47,0	6,5	19,0	0,09
EVN-2	NW 8	G1/4"	50,0	18,0	31,0	54,0	6,0	19,0	0,14
EVN-3	NW 10	G3/8"	59,5	22,5	39,0	64,5	6,0	25,5	0,27
EVN-4	NW 12	G1/2"	83,0	28,0	54,0	79,0	8,0	33,0	0,50

Type code

EVN	-...	-...	-...	-...	-...	-...
						Option omit = valve body in brass NI = valve body in brass, nickel-plated (on request)
						Sealing omit = NBR o-ring V = FKM o-ring (Viton)
						Slot width in mm (only with special execution MF) 0,16 0,20 0,30 0,40 0,50
						MF = micro fine adjustment (on request)
						Thread G1/8" G1/4" G3/8" G1/2"
						Nominal size 1 2 3 4
						Throttle valve adjustable

Ordering example

- Throttle valve adjustable, with annular gap
- Nominal size 2
- Thread G1/4"
- Sealing NBR

or

- Throttle valve adjustable, with micro fine adjustment
- Nominal size 2
- Thread G1/4"
- Eroded slot, width 0,20mm
- Sealing FKM

Type designation

EVN-2-G1/4"

EVN-2-G1/4"-MF-0,20-V

Application notes

The maximal operating pressure must not be exceeded and any pressure peaks must be taken into consideration.

Buyers bear the sole responsibility for ensuring that the selected products are suitable for their applications. Buyers normally establish this by undertaking qualification programs on test stands, or by evaluating the performance of prototype machines or systems.